

# Aluminum Housed Wirewound Resistor - AH Series



## FEATURE:

- High power rating, small size and ultra precision.
- Standard winding & non-inductive winding types.
- High stability, strong construction.
- Suitable for vehical

## GENERAL SPEC:

- Wattage Range: 6 styles to choose ranging from 5 to 250 watts.
- Resistance Tolerance: 10%, 5%, 3%, 2%, 1%, 0.5%
- Operating Temperature Range: -55% to +275
- Dielectric Strength: AH-5 AH-10 AH-25 1000V AH-50 1500V AH-100 AH-250 2500V
- Temperature Coefficient of Resistance: Standard T.C.:  $\pm 30\text{PPM}/^\circ\text{C} = 10\Omega$  and up,  $\pm 50\text{PPM}/^\circ\text{C} = 1$  to  $9.99\Omega$ ,  $\pm 90\text{PPM}/^\circ\text{C} = \text{below } 1\Omega$

**AH-5W  
AH-10W  
AH-25W  
AH-50W**

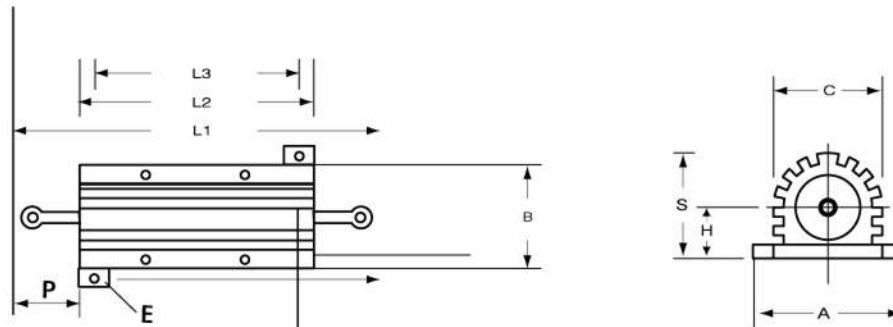

**AH-80W  
AH-100WS**

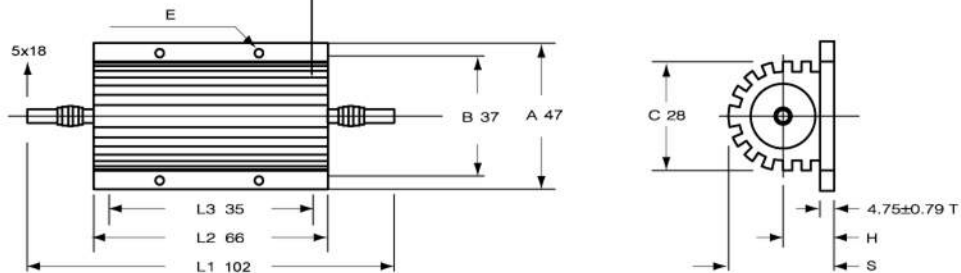

**AH-100W**

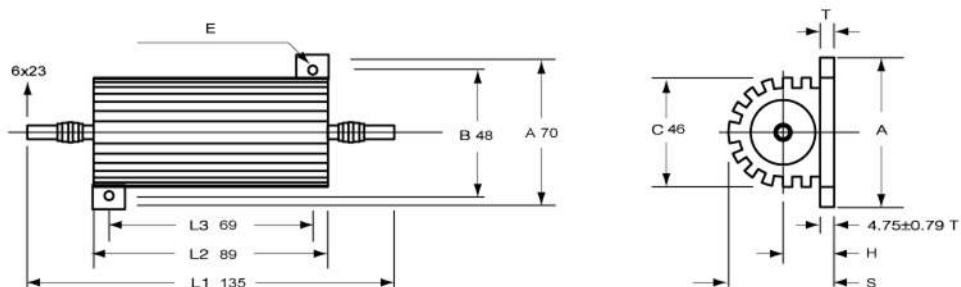

**AH-200W  
AH-250W  
AH-300W**

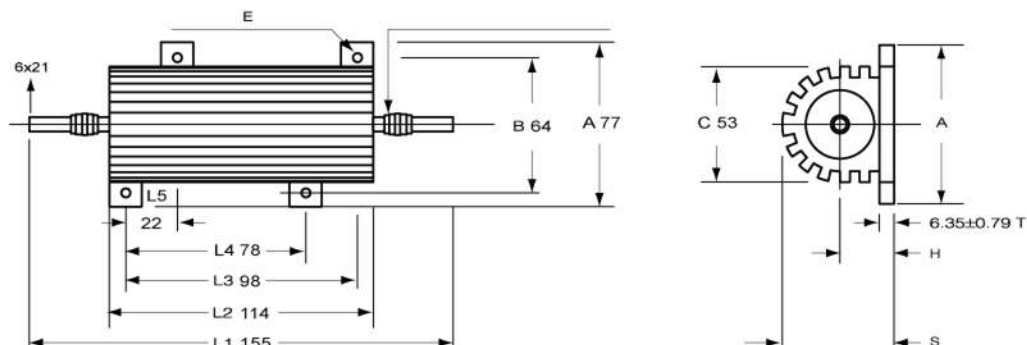



Type	DIMENSIONS(mm)											Resistance Range
	L1±2	L2±1	L3±1	A±1	B±1	C±1	E±0.3	S±1	H±0.5	P±2		
AH-5W	25	15	10	16.5	12.5	8.5	2	8	4	5	0.1Ω~50K	
AH-10W	32	19	14	20	15.5	10.5	2	10	5	6	0.1Ω~50K	
AH-25W	47	27	18	27	19	15	3.2	15.5	7	10	0.1Ω~100K	
AH-50W	70	50	39	29	21	15	3.2	15.5	7	10	0.1Ω~100K	
AH-80W, AH-100WS	102	66	35	47	37	28	4.5	25	12	5*18	0.1Ω~100K	
AH-100W	135	89	69	70	48	46	5	44.5	19	6*23	0.1Ω~3K	
AH-200W, 250W, 300W	155	114	98	77	64	53	5	55.5	25	6*21	0.1Ω~3K	

### Short-time Overload Rating

Load Time (Second)	1	2	3	4	5	10	30	60	180	300	600	900
Power Increase (%)	2600	2000	1600	1400	1300	1000	600	450	200	150	120	110

### Electrical Specification

Characteristics	Limits	Test Methods
Resistance Tolerance	Resistance $1\Omega \leq R \pm 5\%$ (J) Resistance Tolerance $1\Omega \leq R \pm 10\%$ (K)	JIS-C-5202 5-1
Temperature Coefficient	$\pm 200\text{ppm}/^\circ\text{C}$ max.	JIS-C-5202 5-2b
Power Rating Load	$\Delta R/R \leq \pm (1\% + 0.05\Omega)$ Surface Temp. Rise $350^\circ\text{C}$ max.	JIS-C-5202 5-4
Short-Time Overload	$\Delta R/R \leq \pm (2\% + 0.05\Omega)$ 100% Rated Power 5 Seconds	JIS-C-5202 5-5
Insulation Resistance	DC500V 100MΩ min	JIS-C-5202 5-6
Dielectric Withstanding Voltage	AC3000V 60Sec.	JIS-C-5202 5-7

